

Setting-Up and Using Your KB-IR1 InfraRed keyboard

KENWOOD

Congratulations! Your KB-IR1 IR keyboard will make it quicker and easier for you to program disc and track titles into your Kenwood 200 disc CD changer.

Since your keyboard duplicates the functions of the remote control that was included with your CD changer, before using it you should read your CD changer's instruction manual to become familiar with all of the different functions that can be controlled by the remote and keyboard.

1. Removing the Battery Cover

Remove the battery cover by pressing down on the embossed arrow and sliding the cover off in the direction indicated by the arrow in the diagram to the right.

2. Selecting the Model

Important: Your keyboard is designed to be used with several different models of Kenwood CD players.

Before installing the batteries you must set the "DIP" switches located beneath the battery cover to match your particular changer model.

Set the DIP switches to match your changer's model according to the diagram to the right.

3. Installing the batteries

After removing the battery cover and setting the DIP switches as described above, insert 2 "AA" batteries (not included) as shown in the diagram to the right.

Replace both batteries with fresh ones when the "Batt Low" indicator (located on the top of the keyboard) is lit.

Battery Information

To maximize battery life, your keyboard has a Sleep Mode, and is only "on" when you are pressing a key. When you are not using your keyboard store it so that the keys are not accidentally being pressed.

If you're not going to be using your keyboard for a long period of time, remove the batteries.

4. Operating Range

When using your keyboard, point its front edge (where the IR transmitter is located) towards the CD changer.

The keyboard will operate up to 20 feet away and 30 degrees off-axis from your CD player. If you use the keyboard outside of this range, it may not function properly. See the diagram to the right.

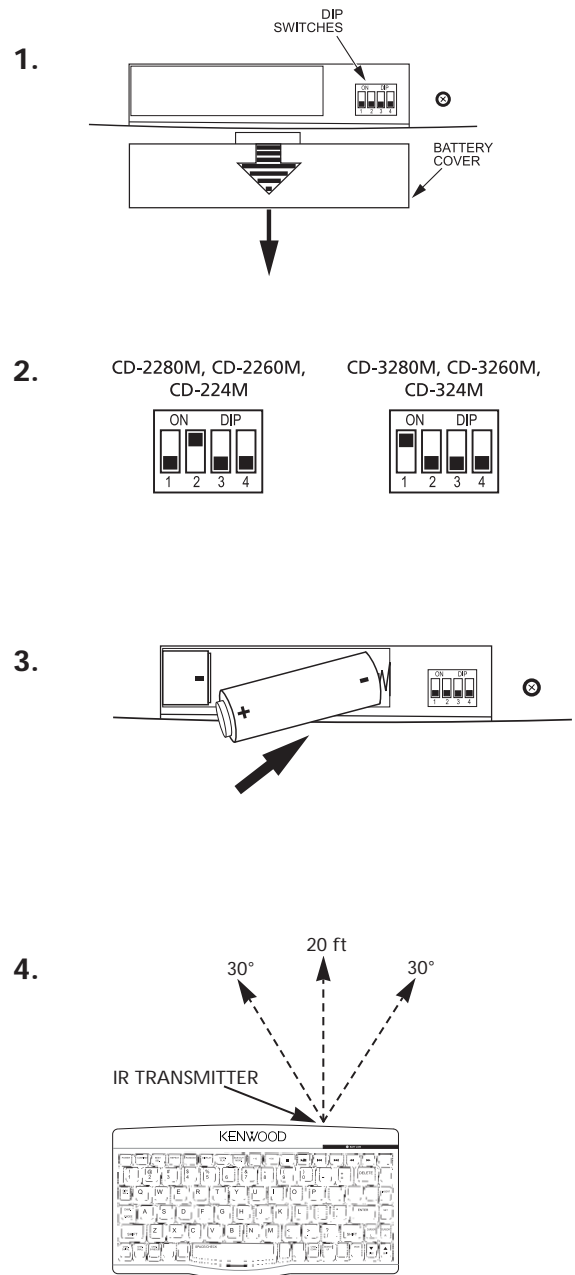

NAMING DISCS AND TRACKS

Discs can be given names (up to 25 characters). On the CD-3280M, CD-3260M, CD-2280M and CD-2260M, up to 20 tracks per disc can also be named (up to 15 characters each).

Although the most convenient time to enter disc and track names is when you insert the discs into the player for the first time, (that way the player keeps track of the disc names for you as you insert the discs), you can use this procedure to enter or change disc and track names any time you want.

These instructions explain how to enter disc names when you insert the discs into the player for the first time.

A. Open the loading door and leave it open for this entire operation

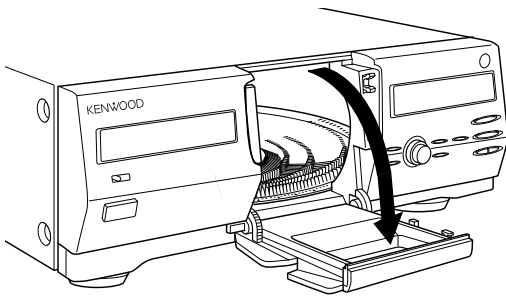

B. Select an empty disc slot

1. Press the **DISK SEL.** key.
2. Use the number keys to enter the disc number.
3. Press the **SET** key.
4. The disc tray will spin around until the disc slot you've selected is in the open loading doorway.

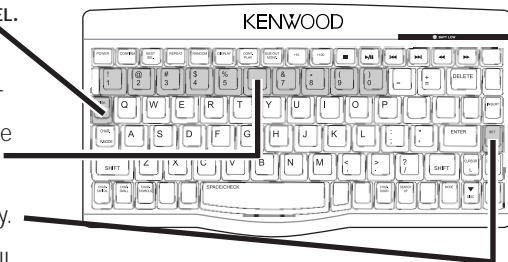

For other ways to select a disc slot, refer to the changer's instruction manual.

C. Insert a CD in the empty slot. Make sure the label faces towards your right.

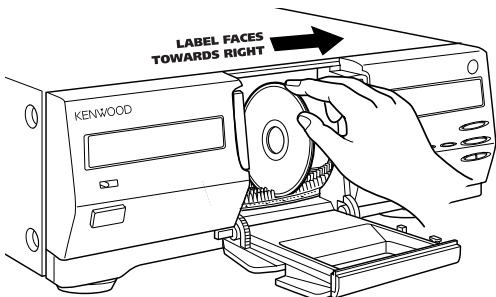

D. Enter the Disc Name

- 1: Press the **MODE** key.
The display flashes:
TITLE INPUT

- 2: Press the **SET** key.
D--- **T---**
disc number
DXXX

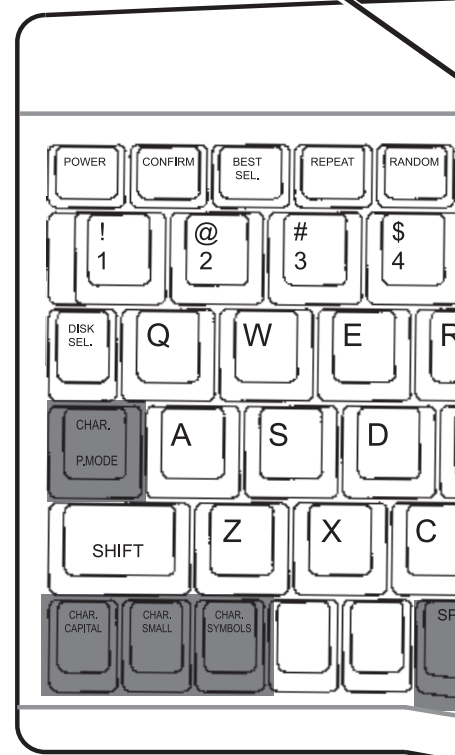

IMPORTANT NOTES A

All models:

- Instead of the **SHIFT** key, use the **CHARACTER/P.MODE** key to shift between capital letters, lowercase letters and numbers/symbols.
- Use the **CHARACTER/P.MODE** key to enter special characters.
- If you make a mistake, use the **CURS** keys to move the cursor. Press the **DELETE** key to delete a character.
- Use the **SHIFT** key to select the secondary symbols on the number and symbol keys.

key. The display reads:
SELECT, then the
you selected will flash:

3: Press the **SET** key again. The display
will stop flashing and will change
to the alphanumeric character dis-
play: █ =>ZABC

4: Use the keyboard to type the disc name. Wait until you
see the alphanumeric character list on the changer's dis-
play before typing. Typing too soon can cause undesired
operation of the changer.

For more information about typing, see the notes at the
bottom of the page.

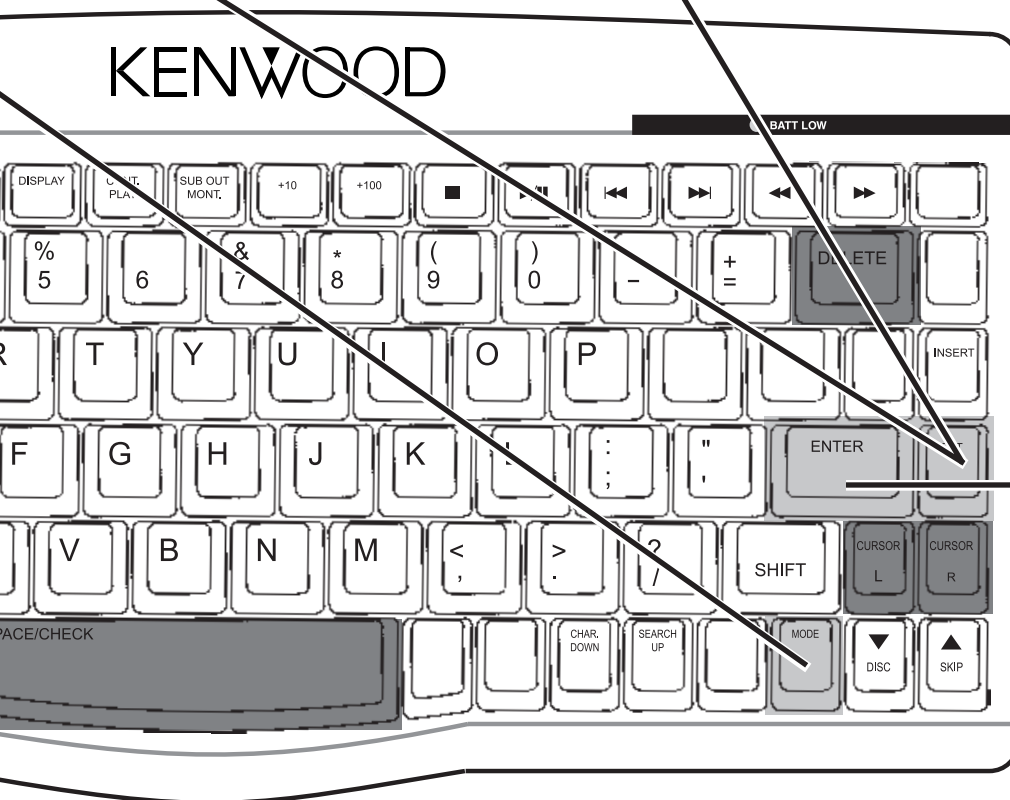

5: After you have typed-in the
entire title, press the **ENTER**
key. The display reads:
TITLE STORE!!

6: The display then switches to
show the disc number, and
the first track number flashes:
DXXX T01

7. Repeat steps 3 - 5 to enter a
title for the disc's first track.

8. Repeat steps 3 - 5 for each
track title you want to enter.

Discs with CD Text

Some record companies encode
CD Text information (titles, artists,
musical genre, etc.) onto their
CDs. Your Kenwood changer will
read this CD Text information and
it will overwrite any title or musi-
cal genre information that you
input into the changer.

ABOUT TYPING (keys shown in dark gray)

SPACE/CHECK key to
spaces.

make a mistake, use
CURSOR L and **CURSOR R**
highlight the incor-
rect character, then use the
DELETE key to erase it.

- Additional symbols not
found on the keyboard can
be accessed by selecting the
number/symbol mode, and
then using the **CHAR. SEARCH**
UP/DOWN keys to scroll-
through the available sym-
bols.

CD-3280M, CD-3260M, CD-324M:

- You can also use the **CHAR CAPITAL**,
CHAR SMALL and **CHAR SYMBOLS** keys to
shift between capital letters, lower-
case letters and numbers/symbols.

CD-2280M, CD-2260M, CD-224M:

- To store a number as part of a title,
press the **SET** key after typing the num-
ber.
- You cannot access yellow-colored sec-
ondary symbols.
- Since the keyboard must transmit a
series of commands each time you
press a key, it may seem to respond a
bit more slowly than a typical wired
computer keyboard.

KENWOOD LIMITED WARRANTY

KENWOOD products are designed and manufactured with advanced technology and craftsmanship. This product is warranted to be free from defects in material and workmanship as listed. This limited warranty remains in effect for the period indicated from the date of the original consumer purchase.

90 days parts and labor

LIMITATIONS OF LIMITED WARRANTY

Except as specified below, this warranty covers all defects in material and workmanship for this product. The following items are not covered under the terms of this limited warranty:

1. Voltage and/or line frequency conversions.
2. Damage caused by accident, negligence, misuse, abuse, improper operation, unauthorized product modification or failure to follow instructions contained in the instruction manual.
3. Periodic check-ups which do not disclose any defects covered by the warranty.
4. Installation and/or removal charges, damages based upon inconvenience, or loss of use of the product.
5. Units on which the serial number has been defaced, modified, or removed.
6. Damage resulting from repair or attempted repair by someone other than KENWOOD, or an Authorized KENWOOD Service Center.
7. Damage due to unsuitable packing and/or shipment method.
8. Cosmetic items such as external cabinet, including but not limited to appearance items such as keys, battery cover, and batteries.
9. Product purchased or serviced outside the United States and its territories, except product purchased through the United States Military Exchange.
10. Damage resulting from installation of parts or accessories which do not conform to the specification and quality of the original item.

WARRANTY COVERAGE

KENWOOD will exchange the items covered under the terms of the limited warranty. This warranty is extended only to the original purchaser. A purchase receipt or other proof of date of original purchase will be required before any warranty service is rendered.

HOW TO OBTAIN WARRANTY SERVICE

If you purchased the KENWOOD product from an authorized dealer:

If your KENWOOD product requires service, return it to the dealer you purchased it from for exchange only.

You are responsible for transporting product for repair, for installation and removal charges, and payment for any initial shipping charges. KENWOOD will pay for the return shipping charges for any product which is received in this manner.

If you purchased the KENWOOD product directly from KENWOOD:

Send it, *along with a copy of the original purchase receipt and packing list*, to the following address for exchange:

KENWOOD USA c/o EFS
2741 Dow Ave.
Tustin, CA 92780

If you have any questions after you have shipped the product, call (800) 736-0727, or E-mail shop@kenwoodusa.com.

You are responsible for transporting product for repair, for installation and removal charges, and payment for any initial shipping charges. KENWOOD will pay for the return shipping charges for any product which is received in this manner.

LIMITATION OF IMPLIED WARRANTIES

ALL IMPLIED WARRANTIES, INCLUDING WARRANTIES OF MERCHANTABILITY AND FITNESS FOR A PARTICULAR PURPOSE, ARE LIMITED IN DURATION TO THE LENGTH OF THIS WARRANTY.

EXCLUSION OF CERTAIN DAMAGES

KENWOOD'S LIABILITY FOR ANY DEFECTIVE PRODUCT IS LIMITED TO THE REPLACEMENT OF SAID PRODUCT, AND SHALL NOT INCLUDE DAMAGES OF ANY KIND, WHETHER INCIDENTAL, CONSEQUENTIAL, OR OTHERWISE. SOME STATES DO NOT ALLOW EXCLUSION OR LIMITATION OF INCIDENTAL OR CONSEQUENTIAL DAMAGES, SO THE ABOVE LIMITATIONS AND EXCLUSIONS MAY NOT APPLY TO YOU.

This warranty gives you specific legal rights, and you may also have other rights which vary from state to state.

If a problem develops during or after the Limited Warranty Period, or if you have any questions regarding the operation of the product, you should contact your KENWOOD Authorized Dealer. If the problem or your question is not handled to your satisfaction, please contact our Customer Service Department at the address listed below.

KENWOOD USA CORP.

2201 E. Dominguez St, Long Beach, CA 90810-5745
Telephone: (800) KENWOOD
E-mail: info@kenwoodusa.com
Internet: www.kenwoodusa.com

Repetitive Stress Injury

Continuous use of a keyboard may cause Repetitive Stress injuries or related injuries. If you feel any aching, numbing or tingling in your arms, wrists or hands, consult a qualified health professional. To reduce your risk of repetitive stress injury:

- Take frequent breaks from typing
- Maintain a straight wrist position
- Avoid resting on your wrists while typing
- Use a light touch on the keys
- Maintain good health habits

Some studies suggest that long periods of repetitive motion coupled with an improper work environment and incorrect work habits may be linked to certain types of physical discomfort or injury. These include Carpal Tunnel Syndrome (CTS), Tendonitis, and Tenosynovitis. To help avoid these conditions, follow the instructions above. These instructions may not only help minimize your chances of experiencing one of these conditions, but will also help you work more comfortably and effectively. It is very important that your chair, work surface, and keyboard are in the proper position.